

## Hydraulic roller cartridge CGH

### Specifications

- Used to create rolling surfaces of different sizes and shapes
- Built into the bolster, can be used when there is no available slot
- Adapted housing machined into the bolster or the sole of the die
- Hydraulic piston lifting
- Different sizes and capacities
- Specific sizes and shapes on request
- Standard working temperature of up to 70 °C, 160 °C with Viton seals



**CGH 200**

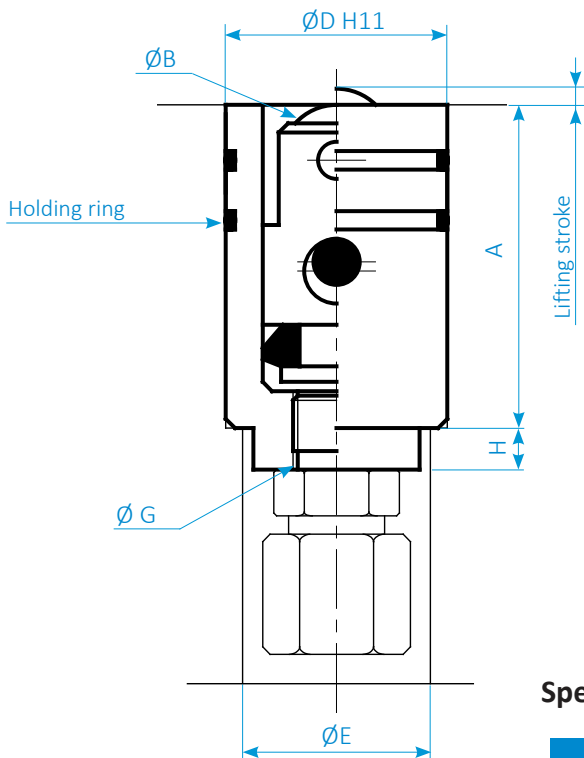

**CGH 1000**

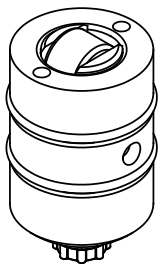
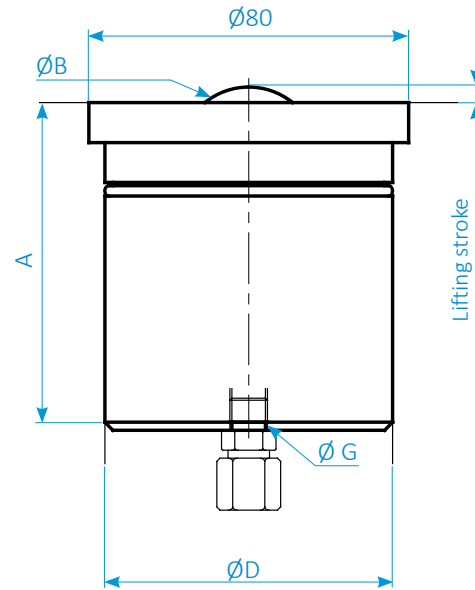

Locating holes on the top of the body to align during installation.

### Specifications and dimensions

	CGH 200	CGH 1000
Force (kN)	2	10
Max. pressure (bar)	100	100
A (mm)	48	95
Ø B (mm)	16	35
Stroke (mm)	3	5
Ø D (mm)	35	72
Ø G	G1/8"	G1/4"
H (mm)	6	-
Ø E (mm)	20	-

To calculate the allowable dynamic load for each roller, please refer to sheet 010-00.

### Purchase order references

CGH 200  
CGH 1000

All dimensions are in millimeters.

SERAPID France  
+33 (0)2 32 06 35 60  
info-fr@serapid.com

SERAPID Deutschland GmbH  
+49 (0)7931 96 47-0  
info-de@serapid.com

SERAPID Ltd  
+44 (0)1359 233335  
info-uk@serapid.com

SERAPID INC.  
+1 586 274 0774  
info-us@serapid.com